

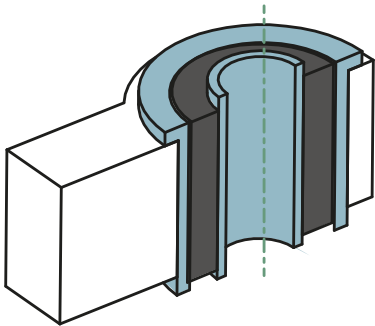

Removal of metal-rubber-metal bushing and installation of non-glued metal-PU or metal-rubber bushing (Manual #16)

BEFORE REPLACING



REMOVAL PROCESS

1

TO REMOVE THE BUSHING PUSH UPPER SURFACE OF THE INNER BUSHING WITH THE USE OF PRESS

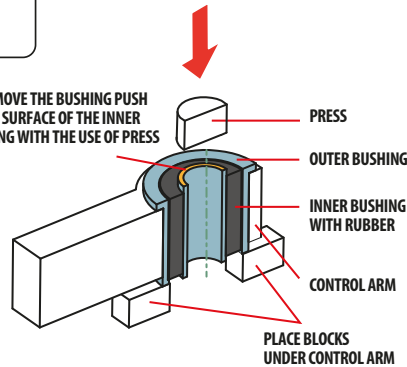

REMOVE THE INNER SLEEVE WITH THE RUBBER, LEAVING THE OUTER BUSHING IN THE SOCKET

2

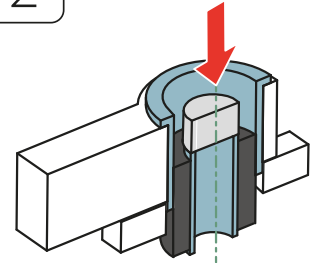

AFTER REMOVING THE INNER BUSHING ALONG WITH THE RUBBER, IT IS NECESSARY TO CLEAN THE OUTER BUSHING FROM RUBBER RESIDUES

CORRECTLY DISASSEMBLED ELEMENT

ATTENTION!
REMEMBER TO MAKE A CHAMFER BEFORE INSTALLING THE NEW ELEMENT

ATTENTION!
BEFORE ASSEMBLY, THOROUGHLY CLEAN THE ENTIRE SOCKET OF ALL CONTAMINATION

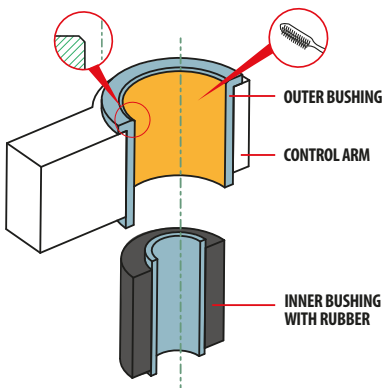

INSTALLATION

1

SURFACES TO BE COVERED WITH GREASE

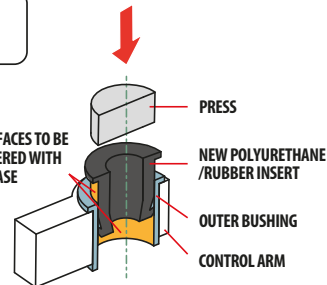

ALL ELEMENTS SHOULD BE PROPERLY LUBRICATED WITH THE SUPPLIED GREASE

2

SURFACES TO BE COVERED WITH GREASE

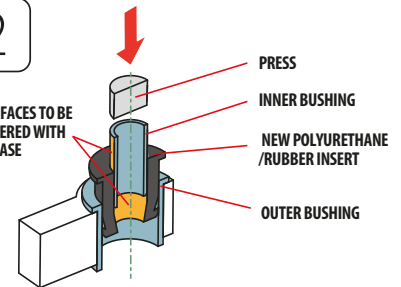

PRESS THE NEW POLYURETHANE INSERT ON ITS HALF LENGTH, THEN PRESS IT

3

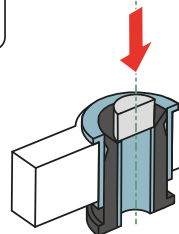

PUSH THE NEW INSERT UNTIL THE LOWER FLANGE COMES OUT OF THE LOWER PART OF THE CONTROL ARM

4

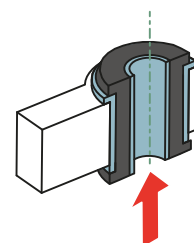

PRESS THE INSERT FROM THE BOTTOM TO ALIGN IT